

- 4-Exterior Weather & Air Barrier
- 5-Thermal Insulation
- 17-Rafter
- 28-FTT U6 FAKRO pivot window
- 31-Thermal insulation of FAKRO flashing
- 38-Installation bracket
- 109-Vapor Barrier
- 227-EBV-AT THERMO flashing side element FAKRO
- 228-EBV-AT THERMO flashing upper element FAKRO
- 229-EBV-AT THERMO flashing lower element FAKRO

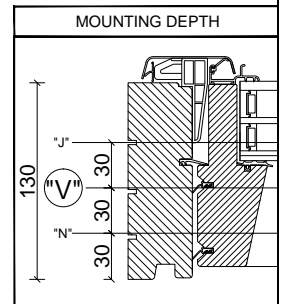

FTT U6 THERMO - DIMENSIONS

Window size[in]	B [in]	B [mm]	L [in]	L [mm]	Rough opening			
					W [in]	W [mm]	R [in]	R [mm]
30x46	30 3/4	777	46 1/2	1180	32 1/4	817	48	1220
30x55	30 3/4	777	55	1400	32 1/4	817	56 1/2	1440

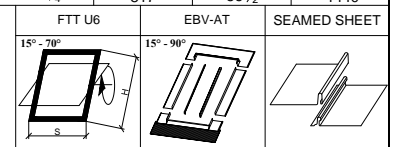

Vertical and horizontal cross-section:
FTT U6 roof window with EBV-AT THERMO
flashing for flat tiled roofs (SEAMED SHEET)

FORMAT: A3	SCALE: 1:10/1:5	DATE: 03.2021
---------------	--------------------	------------------

Warning! The present drawing is for informational-demonstrative purposes only and as such cannot constitute a basis for performance. All dimensions presented in this drawing should be verified on site. Because of the fact that the drawing is a schematic one, FAKRO shall not assume any responsibility for the actual installation quality on the roof. This drawing is FAKRO's property and cannot be published or used publicly without our written consent.